

MANOMAY

4G PROTECT LINK Pan-Tilt Camera



USER MANUAL

In The Box

Product Information Notice :

This guide pertains to Wi-Fi Pan-Tilt and may differ from the actual product. Refer to the specific product for accurate information. Updates to this manual may occur without prior notice due to product upgrades or other needs.

Product introduction

2MP+2MP 4G Protect Link Pan-Tilt Camera

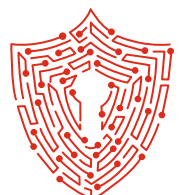
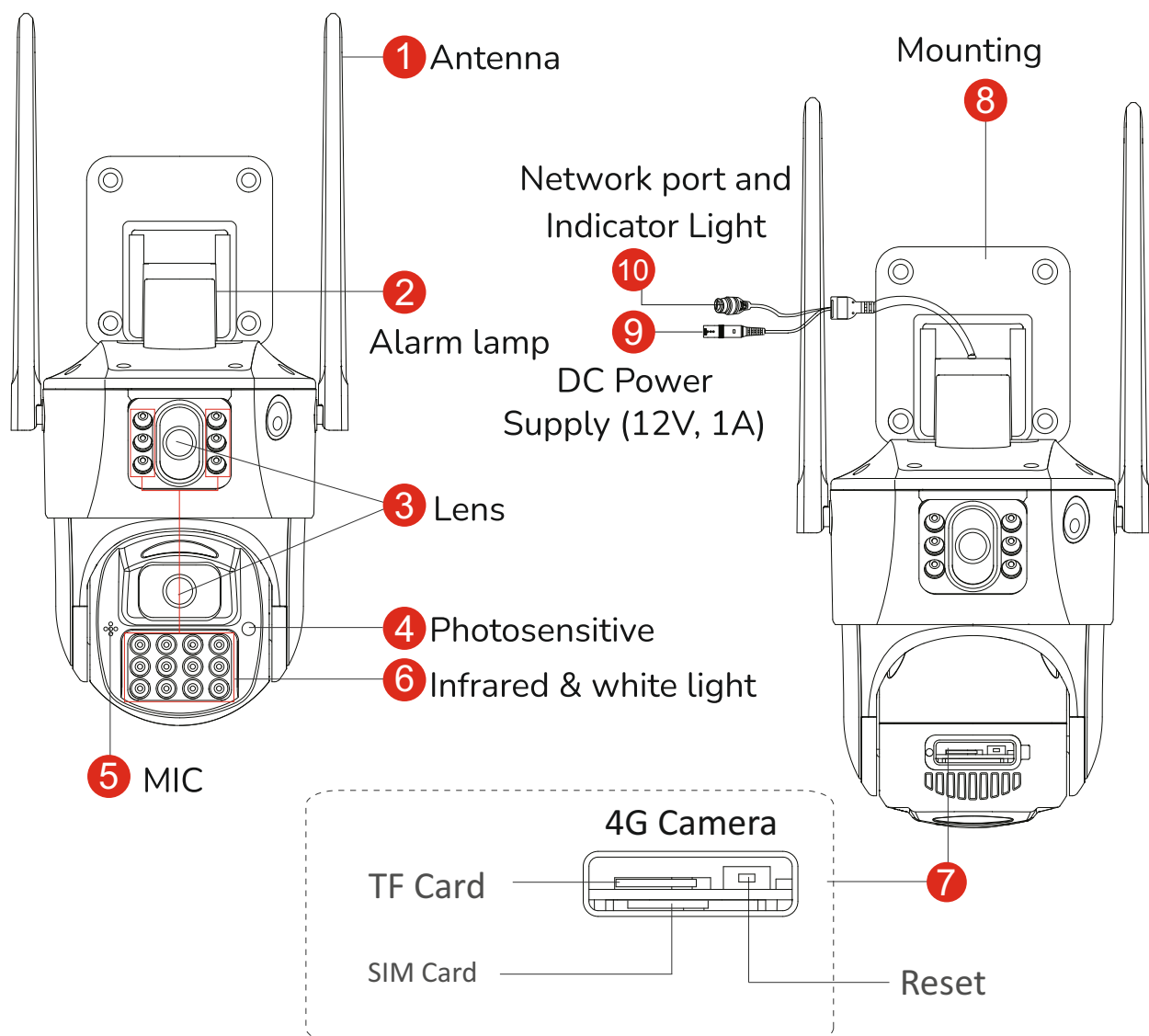

Software Installtion

- APP Download and Installation Users can search for “Manomay App” on store or Google play. You can also Install the App by scanning the QR code



Manomay
Android App



Manomay
iOS App

Note : The App requires iOS version 9.0 or Android 5.0 or above

A] Phone Number Login

Enter mobile no., Click on get verification code. Enter verification code and click on login

B] Account Login

On the login interface, enter the Account login : account/phone number/ email, and the corresponding password, click on log in

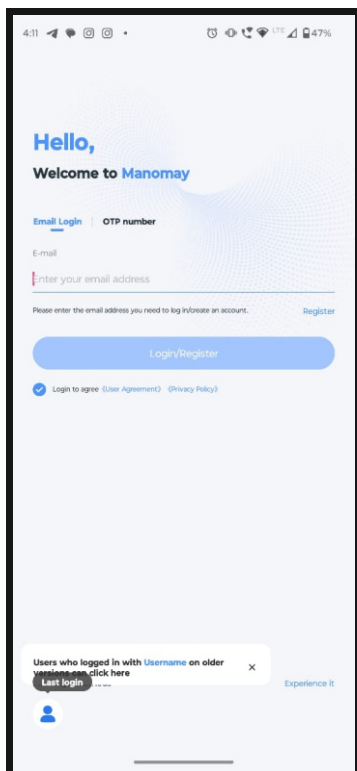

C] 4G SIM Card Installation

1. When the device is powered off, insert a 4G card that can access the Internet into the device

Connect the device to the power supply. Wait for device indicator to turn on.

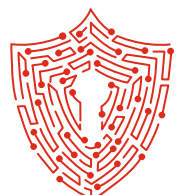
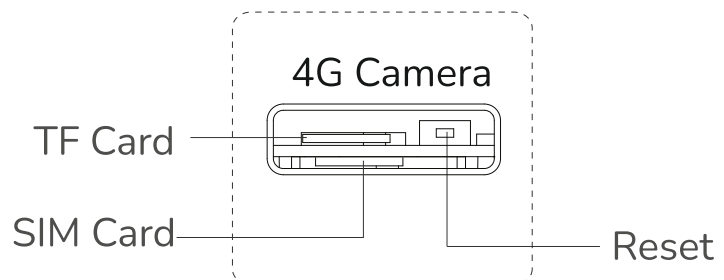

Adding the Camera in App

1. Open the APP and click on the “+” icon on the upper right corner to enter the scan code interface
2. After clicking “+” in the device list a pop-up will appear to enable blue-tooth, click on cancel to disable the same.
3. Click on Scan to Add

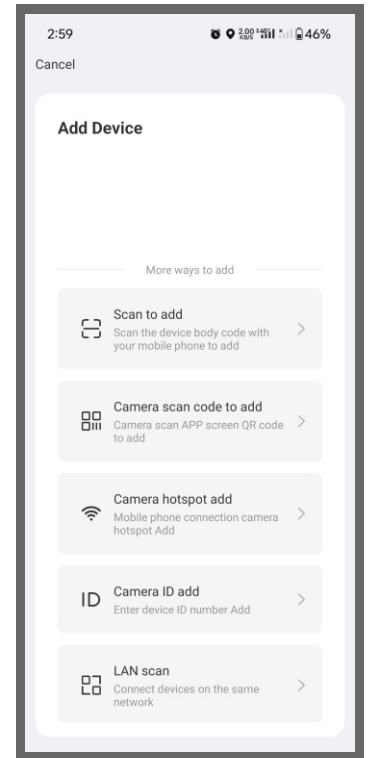
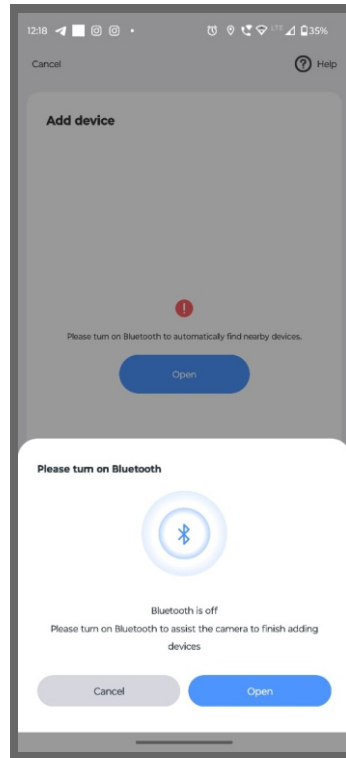
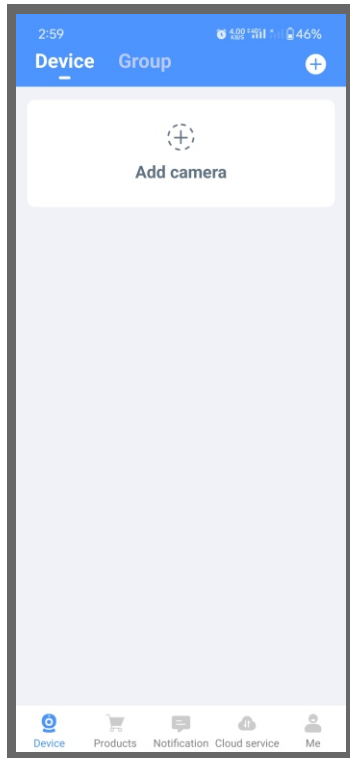

4. Scan the QR code available on the camera
5. On the search device interface

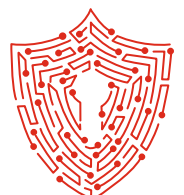
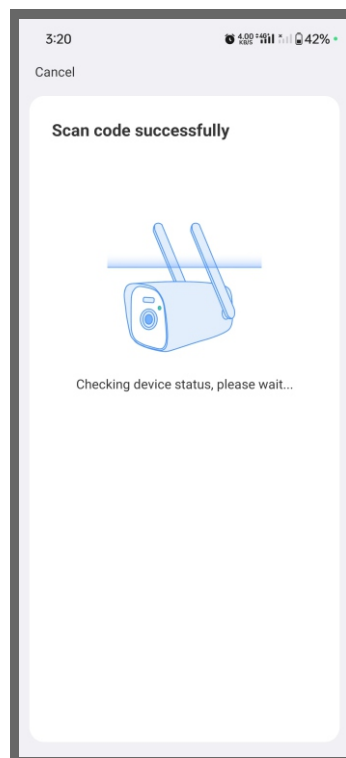
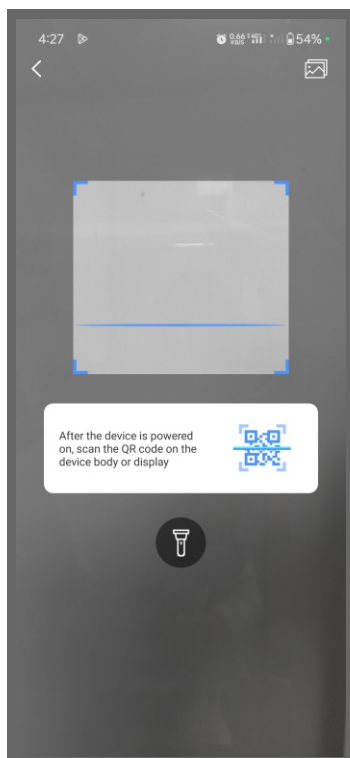

6. Please wait patiently while the device get configure.

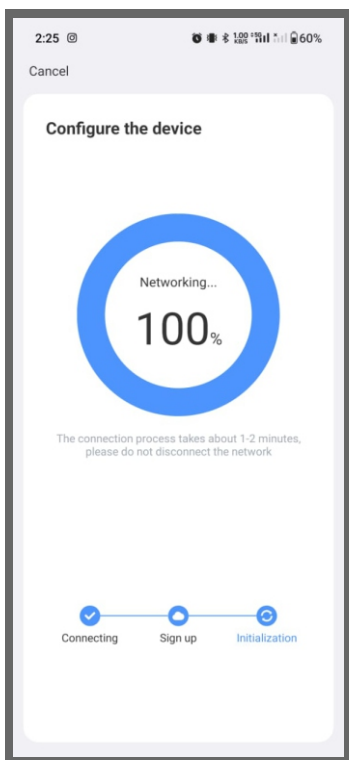

7. Set the name for your device. click on confirm to "ADD" the device successfully

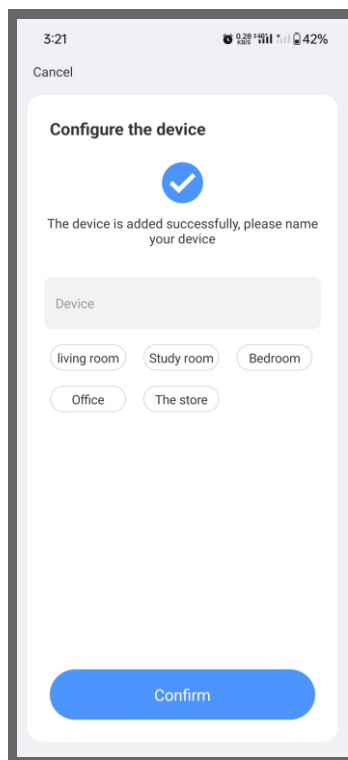

8. After set the device name click on finished

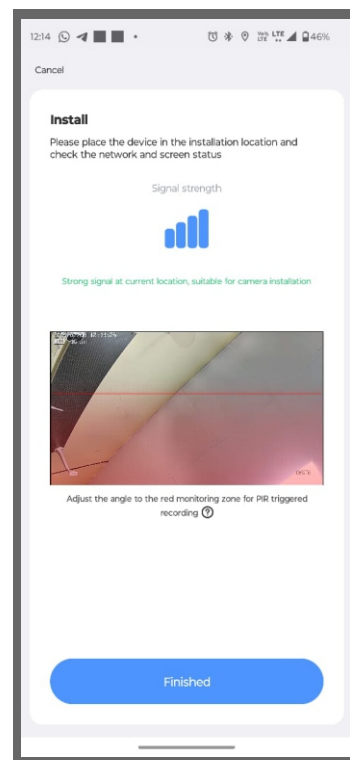

When the QR code on the device is not available or does not work follow the below instructions.

1. Click on "Camera ID ADD"

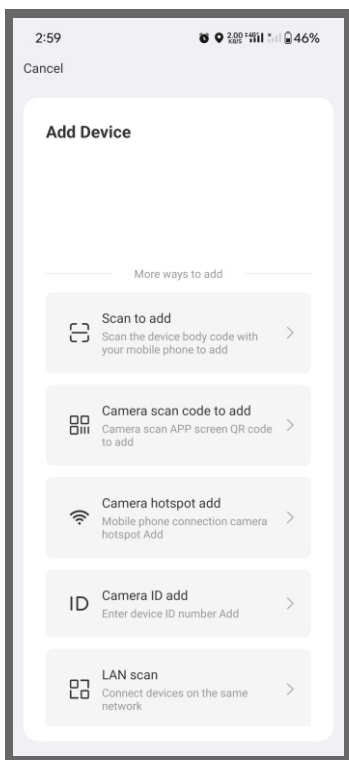

2. Enter the device ID and password and click on confirm to "ADD" the device successfully

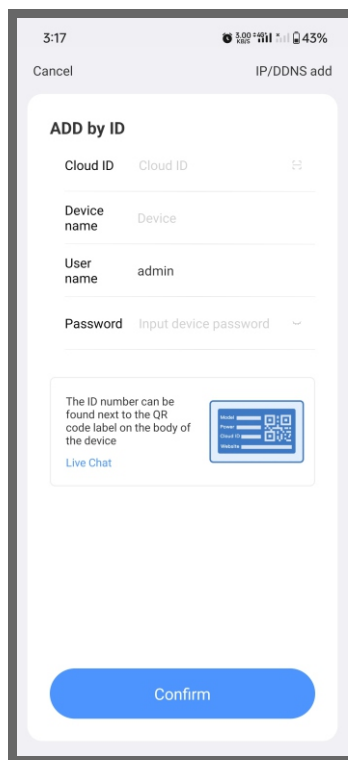

1. To add the camera using wired connectivity

Note : Please remove the 4G SIM card before using the above configuration method.

1. Power ON the device. Connect it to a router with internet access using a network cable. Scan the QR code of the device

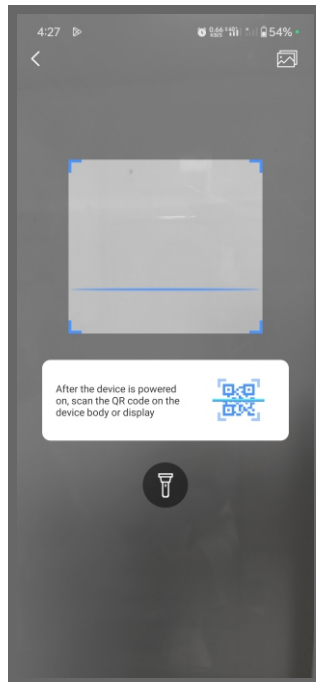

2. Set the name for your device. click on confirm to "ADD" the device successfully

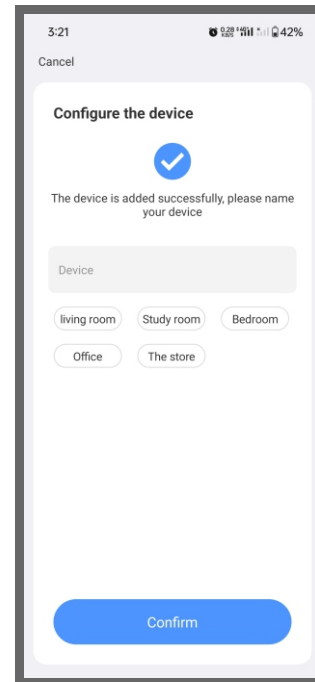

2. Method

1. When the mobile phone and the device are connected to the same network, select "LAN Scan"

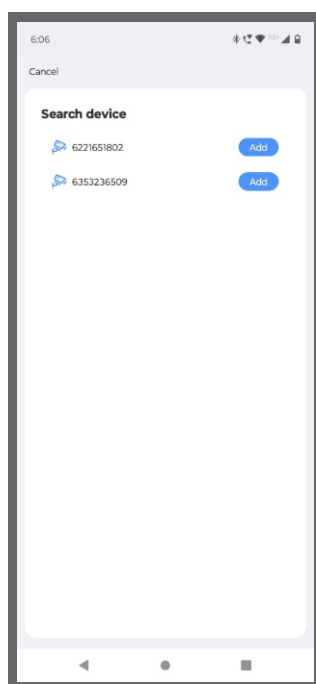

2. After searching for the device click Add and "Password" Click on Confirm

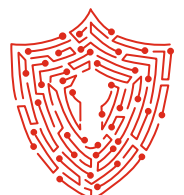
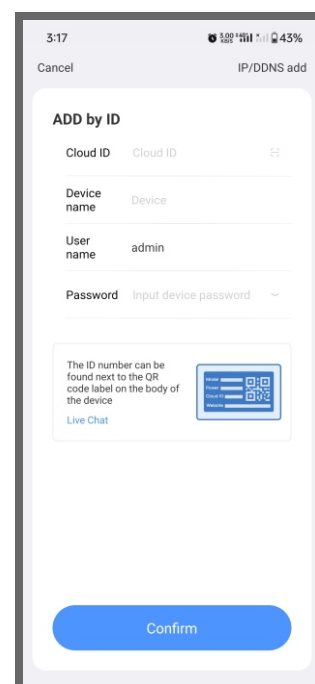

WARNING



In case of fire or lighting, please don't put product in damp and raining place. Operate or maintain only according to the user manual.

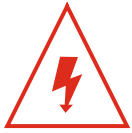

Be careful when you see an attachment with the Dangerous Voltage Sign which might cause serious electric accident

	Warning CAUTION RISK OF ELECTRONIC SHOCK DO NOT AOPEN	
Warning	To reduce electric shock, unprofessional people please don't open product front panel or rear panel	

Warning

In case of electric shock and fire
Please don't use power supply
beyond power list in user manual

Notice

1. Ensure your equity, Please read the user manual carefully before you use the product
2. Please contact professional people if you need install and maintain the product.
3. Working Environment : temperature of -20°C~+60°C, relative humidity under 85%
4. Please do not exceed the standard range of temperature, humidity and voltage as suggested in the user manual.

